

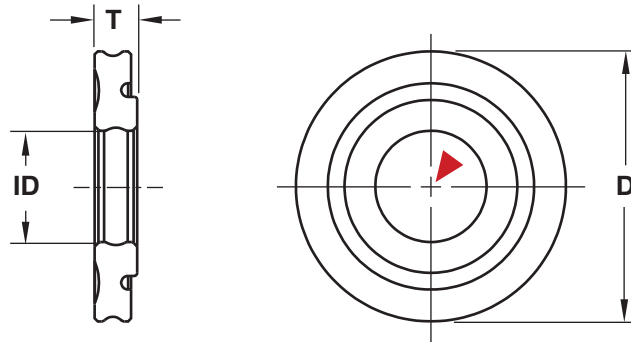

RADIAL SPRINGS

FLOATING INSERT CENTERING SPRING



Inch Standard

M TPA **H** 91A

CATALOG NUMBER	ID STRIPPER BOLT DIAMETER	D POCKET DIAMETER ±.001	T POCKET DEPTH ±.001	MAX INSERT WEIGHT (LBS) FOR 4 SPRINGS
RS250	1/4	.500	.125	50
RS312	5/16	.750	.125	75
RS375	3/8	.875	.125	100
RS500	1/2	1.000	.125	150

Metric Standard

M TPA **H** 91A

CATALOG NUMBER	ID STRIPPER BOLT DIAMETER	D POCKET DIAMETER ±.03	T POCKET DEPTH ±.03	MAX INSERT WEIGHT (KG) FOR 4 SPRINGS
RSM06	6	12	3	22
RSM08	8	16	3	35
RSM10	10	20	3	45
RSM12	12	24	3	70

▶ CAD insertion point

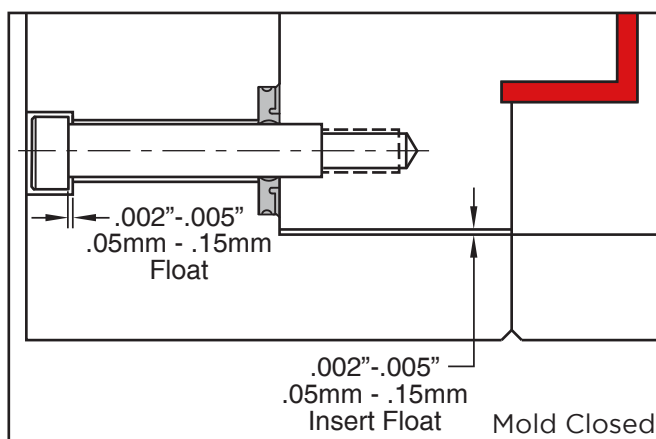
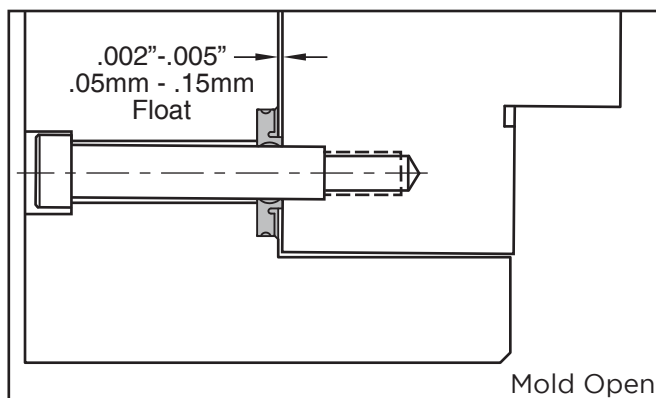

APPLICATION GUIDELINES

- Radial Springs both lift and center floating inserts before locks engage to protect telescoping shut offs.
- Install on core half as shown below.
- For best performance, use four Stripper Bolts and Radial Springs per insert with four Cavity Locks. Inch Stripper Bolts are sold on page B-30 and both Inch and Metric Cavity Locks are on pages C-16 (Flat) and C-17 (Round).
- Max Temperature: 200°F (93°C)

