

# CAVITY INTERLOCKS

## FLAT Z-SERIES

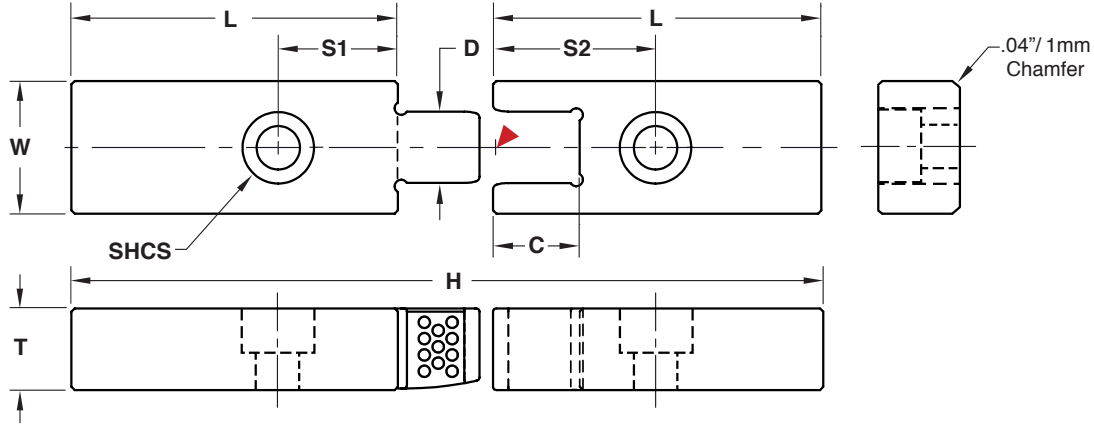

Flat Cavity Interlocks are a space-saving design for mounting directly within a mold's inserts. The overall lengths are sized for nominal plate thicknesses and can be modified for smaller insert heights.



### Inch Standard

Male: **M** H-13 **H** Core: 42-48 HRC, Surface: 70 HRC **S** Salt Bath Nitride

Female: **M** DC53 **H** Core: 58-62 HRC, Surface: 80 HRC **S** Titanium Nitride Coated

CAD insertion point

CATALOG NUMBER	T +.000 -.002	W +.0000 -.0002	L +.000 -.002	C	D .0001/.00015 Clearance Per Side	H +.000 -.004	S1 ±.01	S2 ±.01	SHCS
CF31X62	.312	.625	1.875	.343	.312	3.750	.688	.688	#8-32 x 3/8"
CF50X87	.500	.875	2.875	.530	.438	5.750	1.000	1.000	1/4-20 x 5/8"

Note: 500°F max operating temperature.

Screws included.

### Metric Standard

Male: **M** H-13 **H** Core: 42-48 HRC, Surface: 70 HRC **S** Salt Bath Nitride

Female: **M** DC53 **H** Core: 58-62 HRC, Surface: 80 HRC **S** Titanium Nitride Coated

CATALOG NUMBER	T +.00 -.05	W +.000 -.005	L +.00 -.05	C	D .003/.004 Clearance Per Side	H +.0 -.1	S1 ±.25	S2 ±.25	SHCS
CFM08X16	8	16	46	8.8	8	92	12.5	20	M4-0.7 x 10
CFM12X20	12	20	66	12.8	12	132	18.5	30	M6-1.0 x 14

Note: 260°C max operating temperature.

Screws included.

### Alternative Configurations:

- To order Shuttle Mold sets or special male/female configurations, refer to page C-11.

### MOLD-READY INTERLOCKS

Progressive can supply Flat Cavity Interlocks complete with screw hole locations and lengths modified to suit your application. To order, specify the item code that will be modified from the charts above, and provide the following to Customer Service:

- ML=Male Length
- MS=Male Screw Location (Will be on center.)
- FL=Female Length
- FS=Female Screw Location (Will be on center.)
- Pocket Radius: If required, add "R" to the specification. (Radius is designed to suit Interlock size.)

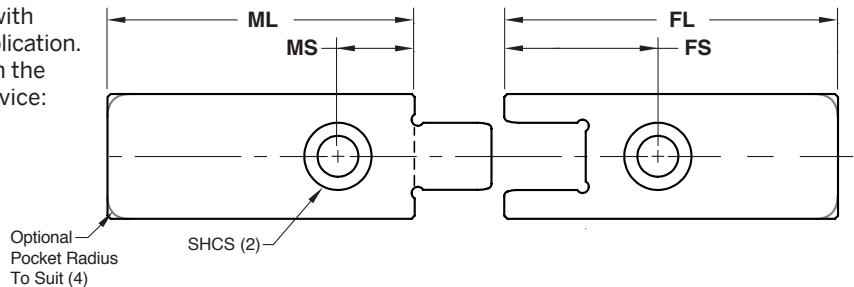

### Notes:

- SHCS size will be the same as within the standards.
- If any specifications are outside of these parameters or locks are required with larger widths or lengths, utilize the template in section X.